

BY	CHK	REVISION RECORD MODIFICATIONS	DATE	REV.
ALLEN		RELEASE TO PRODUCTION	2007,8,3	1.0

**SPECIFICATION**

Current Rate: 3 AMP  
 Insulation Rrsistance: 1000mΩ Min  
 Contact Resistance: 20mΩ Max  
 Dielectric voltage: 1000V AC for one minute  
 Operation Temperature: -40°C to +105°C

**MATERIAL**

Insulator: Polyester,UL94v-0  
 ©Standard: P.B.T or Nylon 6T  
 Contact Pin: Brass  
 Finish: Tin, Gold Plated  
 ©Standard: Gold Flash all over

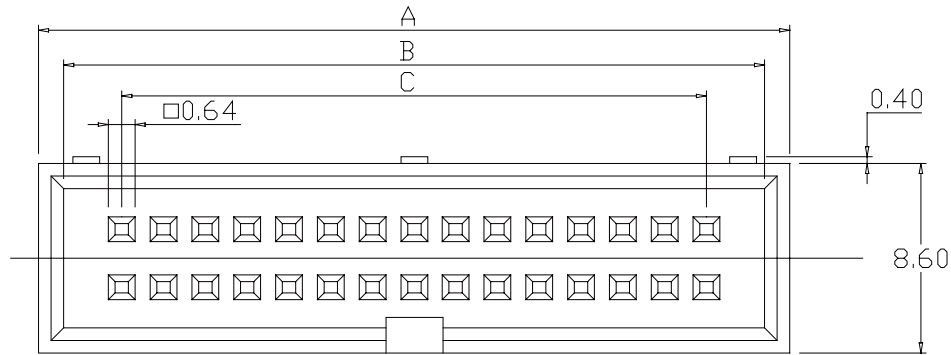

Position	DIMENSION		
	A	B	C
10	20.34	18.00	10.16
14	25.48	23.16	15.24
16	27.90	25.72	17.78
20	33.05	30.80	22.86
26	40.68	38.42	30.48
34	50.80	48.58	40.64
40	58.46	56.20	48.26
50	71.10	68.90	60.96
60	83.80	81.60	73.66
64	89.10	86.68	78.74

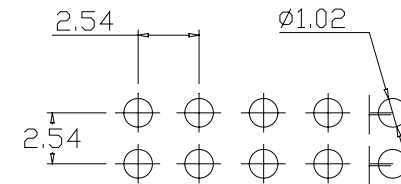
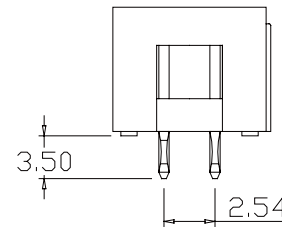
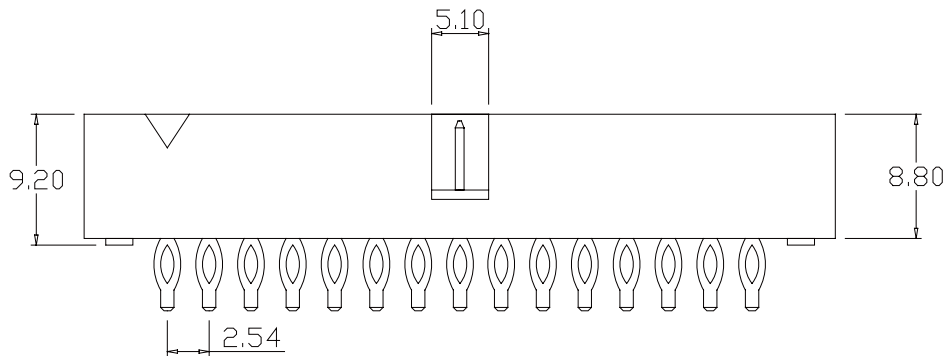

Recommended PCB Layout  
 (PCB TOLERANCE±0.05)

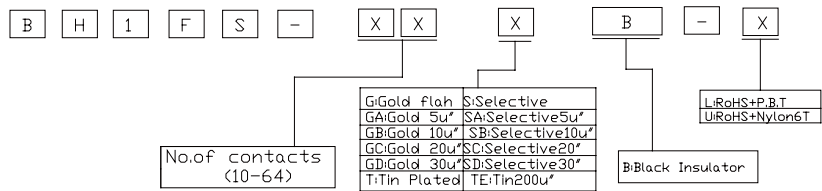

APPRO	CHECK	DRAWN	PART NO.	BH1FS-XXXB-X				DESCRIPTION	
			ITEM NO.						
			DRAW NO.						
			UNIT	mm	SCALE	no			
			TOLER		NO.				
								Tel:0769 22020068 Fax: 0769 22020069 E-mail: sales@vigortec.com	